

OPTIONAL POLE CAP  
356 CAST AL. ALLOY  
SECURED WITH (3) 1/4"-20NC-2  
ST. STL. CUP POINT SET SCREWS

4 1/2" O.D.

6063-T6 PIPE SHAFT  
4' SCHD. 40 PIPE X 'L' LONG  
(SEE DETAIL & CHART)

SHAFT LENGTH  
'L'

POLE ASSEMBLY  
HEIGHT, 'H'

15'  
BASE  
HEIGHT

13 5/8" SQ.

356 CAST AL. ALLOY DOOR  
8 5/8" X 8 5/8" SQUARE

TS-1000 TRANSFORMER BASE  
356-T6 CAST AL. ALLOY  
(1/4"-20NC-2 TAPPED HOLE IN  
BACK WALL FOR GROUNDING SCREW)

SHAFT LENGTH  
'L'

2" APPROX.  
THREAD  
LENGTH

4" NPT PIPE THREAD

PEDESTAL SHAFT DETAIL

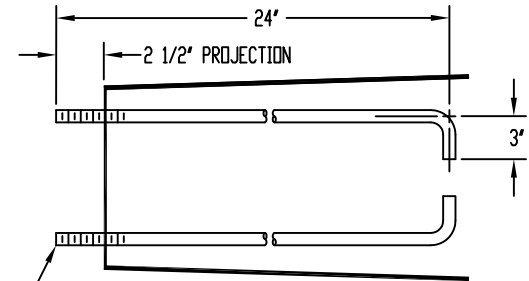
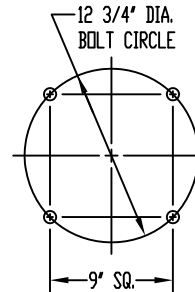

3/4" DIA. X 27" LONG ANCHOR BOLT WITH HEX NUT, LOCKWASHER AND 1/4" THK. X 13/16" I.D. X 2 1/2" O.D. HEAVY FLATWASHER (4 OF EACH REQUIRED). ANCHOR ROD TO BE 55,000 PSI MIN. YIELD STRENGTH PER AASHTO M314-90, GRADE 55. TOP 6' OF ROD TO BE GALVANIZED PER AASHTO M232 CLASS C, (ASTM A153).

PEDESTAL SHAFT CHART	
ASSEMBLY HEIGHT, 'H'	SHAFT LENGTH, 'L'
6' - 0"	4' - 10 3/4"
8' - 0"	6' - 10 3/4"
10' - 0"	8' - 10 3/4"
12' - 0"	10' - 10 3/4"
14' - 0"	12' - 10 3/4"
16' - 0"	14' - 10 3/4"
18' - 0"	16' - 10 3/4"
20' - 0"	18' - 10 3/4"

REVISIONS					MATERIAL	
ALT.	DESCRIPTION	DATE	BY	CHK.	STOCK SIZE	FINISH OR TEMPER.
					CUSTOMER	

95 GNARLED HOLLOW RD.  
EAST SETAUKET, N.Y.  
11733

**P&K**  
TUBULAR PRODUCTS, INC.

TITLE  
**PEDESTAL POLE ASSEMBLY  
TYPE TS-1000 TRANS. BASE**

DR. **W.W.W.** DATE **02-24-09** DWG. NO.  
CHK. **S.A.F.** DATE **02-24-09**  
APP. \_\_\_\_\_  
SCALE **NONE**

9526